

This guide provides a summary of how to make the changes needed to allow the Gateway to work on your Ethernet network. For more detailed instructions see www.hubbell.com/wiringdevice-kellems/en or email techserv@hubbell.com

IMPORTANT: GATEWAY MUST BE CONNECTED TO A NETWORK TO ENABLE CONFIGURATION

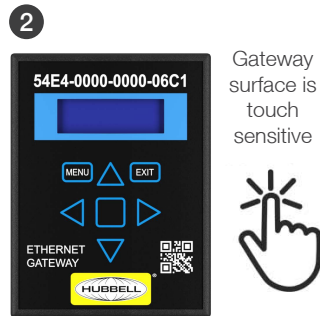

- Insert Ethernet cable into the network port and connect other end to the network.
- Connect the universal power supply provided to 5V DC jack to power the Gateway.
- IMPORTANT:** If either of the Network Status lights is not lit there is no network connection. A network connection must be established before proceeding.



- Unlock by tapping MENU three times
 - Lock by tapping EXIT
- The touch pad automatically locks after 10 seconds without taps.

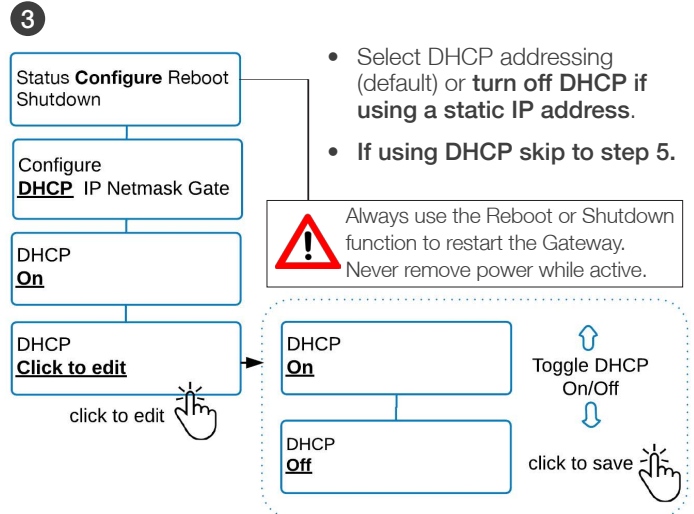

4 SET IP ADDRESS

- With DHCP turned off, enter the IP address, netmask and gateway addresses.
- A temporary IP address can be assigned and modified once you have access to the Gateway.

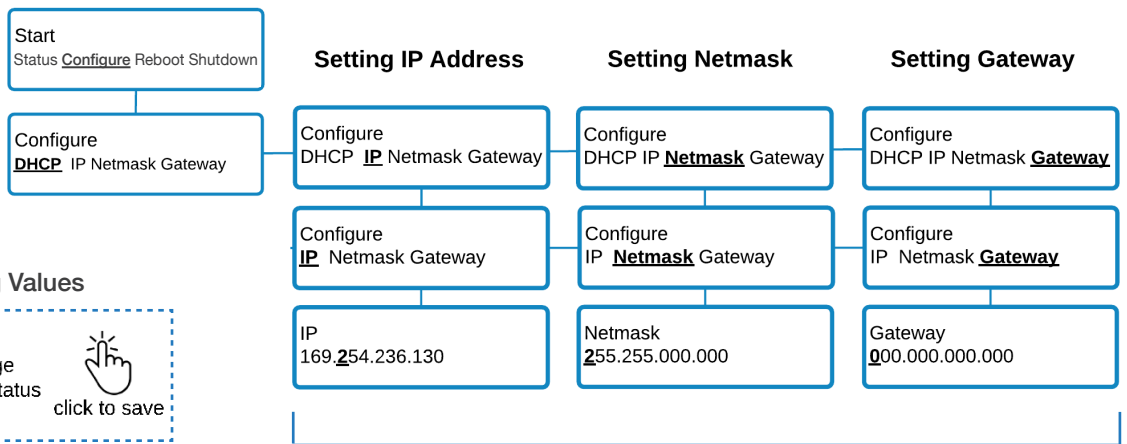
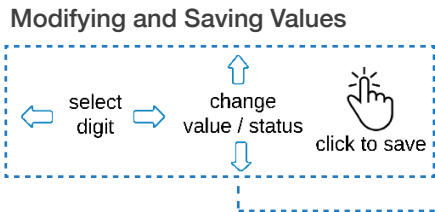

5 ACCESS GATEWAY CONSOLE

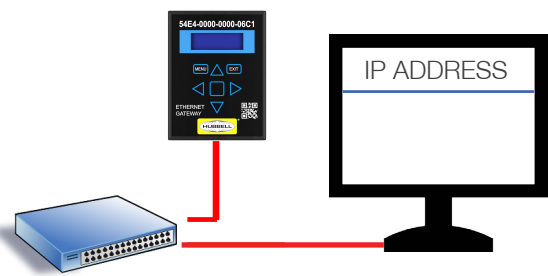

- Access the **Gateway Console** by entering the Gateway's IP address onto a web browser.
- Make sure the Gateway and browser are connected to an accessible switch or router.

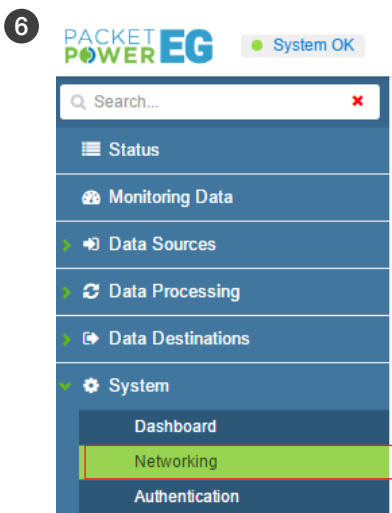

- From the left hand menu select "System" and then the "Networking" tab.



7 NETWORK SETTINGS

Networking

Setup your networking information in order to properly communicate within your network.

Network Interface IP ADDRESS (revealed only with DHCP off)

DHCP: On Off

IP Address:

Netmask:

Gateway IP:

Domain Name Servers (DNS) DNS ADDRESS(ES)

Server 1:

Server 2:

Proxy Server PROXY SERVER(S)

Proxy On Off

Time Synchronization (NTP) NTP SERVER(S)

Server 1:

Server 2:

NETWORK SETTINGS

- Enter the DNS address(s).
- Select a proxy server if applicable (often used when using EMX portal).
- Note that static IP addresses can also be modified here.
- Click “save” icon to input settings.

TIME SYNCHRONIZATION

- Enter an NTP time server IP address or domain name.
- Available servers can be found at <http://www.pool.ntp.org>
- Default time server is 0.pool.ntp.org and 1.pool.ntp.org
- Confirm the time at the top right of console.
- Click “save” icon to input settings.

8 CHOOSE YOUR DATA DESTINATION

EMX

Setup your EMX monitoring data feed and support feed.

Monitoring Data Feed EMX IMPLEMENTATION TYPE

Mode	Select	Destination
Cloud EMX	<input checked="" type="radio"/>	Send monitoring data to cloud EMX. Requires firewall http(s) access to *.amazonaws.com
Local EMX	<input type="radio"/>	Send monitoring data to a local EMX host: <input type="text" value="Local EMX host (ex: https://192.168.0.1)"/>
Disabled	<input type="radio"/>	Do not send data anywhere (for use with SNMP or Modbus)

Upgrade and Support Feed

Mode	Select	Destination
Cloud EMX	<input checked="" type="radio"/>	Enable upgrade information feed from cloud EMX. Requires firewall http(s) access to *.amazonaws.com
Local EMX	<input type="radio"/>	Enable upgrade information feed from a local EMX host: <input type="text" value="Local EMX host (ex: https://192.168.0.1)"/>
Disabled	<input type="radio"/>	Do not use the support data feed

DATA DESTINATIONS

- Click on the “Data Destinations” tab on the left hand menu.
- Select how you want to receive your data: *EMX, Modbus or SNMP*. EMX feeds can be delivered simultaneously with Modbus or SNMP feeds.
- For SNMP or Modbus output ensure the Gateway is licensed correctly as indicated by a green light on the SNMP or Modbus tabs under “Data Destinations”. Contact Packet Power if the SNMP or Modbus feed needs to be enabled.
- For Modbus and SNMP implementation refer to the detailed support pages at packetpower.com/support
- Select the desired EMX implementation type (cloud is default) for both “Monitoring Data Feed” and “Upgrade and Support Data Feed” sections.
- **Ensure that the Gateway's IP address has outbound access to port 443 (HTTPS) for *.amazonaws.com when using cloud EMX.**
- Enter the IP address of the server for local EMX implementation.
- Before you can access your data via EMX make sure your Packet Power representative has set up an EMX account. See the support section for EMX for additional details.